

**Material**

Pressed 1.0mm galvanised steel  
Smooth internal bore reduces  
pressure loss and wear

**Sizes**

Diameter: 80mm – 300mm Bend  
angle: 7.5° to 90°  
 $R = 1.5 \times D$

## Pressed Bends

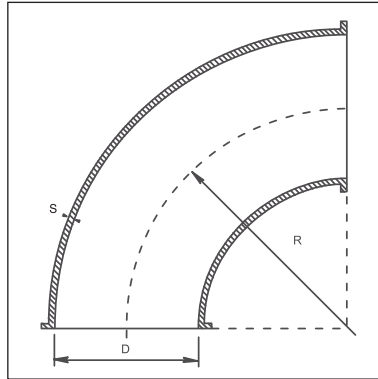
*Code B*

Dimensional specifications are given in  
the table below

### Dimensional Specifications

PRODUCT CODE	D mm	S mm	A	B	C	D	E	F
			90°	60°	45°	30°	15°	7.5°
			Weight - kg					
B80	80	1.00	0.40	0.30	0.20	0.15	0.08	0.05
B100	100	1.00	0.50	0.40	0.25	0.20	0.10	0.08
B125	125	1.00	0.90	0.65	0.45	0.35	0.17	0.12
B140	140	1.00	1.10	0.80	0.55	0.40	0.20	0.15
B150	150	1.00	1.20	0.90	0.60	0.50	0.25	0.20
B160	160	1.00	1.50	1.20	0.75	0.60	0.30	0.25
B180	180	1.00	2.00	1.50	1.00	0.80	0.40	0.30
B200	200	1.00	2.50	1.85	1.25	1.00	0.50	0.35
B225	225	1.00	3.20	2.40	1.60	1.20	0.60	0.37
B250	250	1.00	4.00	3.00	2.00	1.50	0.75	0.40
B275	275	1.00	4.80	3.60	2.40	1.80	0.90	0.43
B300	300	1.00	5.50	4.10	2.75	2.05	1.00	0.50

